

GRADER-LINK™ -24 TRIPLE CARBIDE (Patent Pending)

When safety and performance are critical, choose the VBL™ locking, sectional, triple carbide system. GRADER-LINK™.

Safety: 46lb (20.9kg), 12" (305mm) segments are safe and easy for one person to handle, helping to reduce injury.

Rigidity: The 1-1/2" thick 10" tall locking sectional design makes for a more rigid installation.

Wear: Segments and locks are forged and heat treated for strength. Two rows of solid tungsten carbide inserts and Tungsten Carbide Matrix (TCM) wear protection come standard for extreme wear life.

Managed Trials Available

16107

FOR TRIALS CONTACT GRADE CONTROL 02 43851041

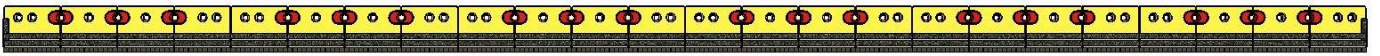

Introduction:

A longer lasting, safer, grader blade designed specifically for 16, 18 and 24 ft mouldboard graders is now available.

Safety:

Borrowing the 12" sectional design from VBL's innovative CARBIT-Link system the individual part weight can be limited to 46lb / 20kg. This makes it possible for one person to safely move and install the segments.

Compare this to traditional blades weighing between 205lb / 93kg (1-½"X10"X48") - 1500lb / 680kg (3"X16"X96") requiring lifting equipment and putting maintenance personnel at risk.

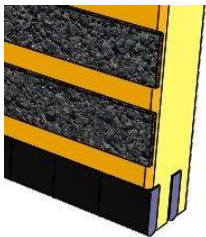
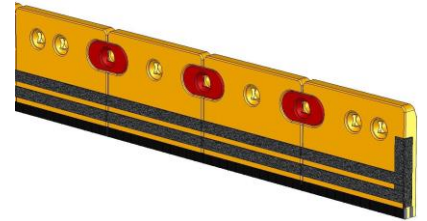

Triple carbide:

The wear surface on the bottom edge is fortified with 2 rows of high wearing tungsten carbide (1" tall). These inserts are protected by a 2" pass of tungsten carbide embedding (TCM).

Base Blade:

A heat treated alloy steel forging provides superior strength and hardness to further protect the carbide. The recessed mating features and bolt holes are hot forged to their final shape. This technique orients the grain structure in these areas resulting in 30% more strength.



End protection:

Additional tungsten carbide embedding is added to the ends of system to prevent premature wear in these areas. As these areas are typically the first to wear out, increasing their wear life can prolong the life of the entire system.

Other benefits:

The sections lock together using the patent pending link plates ensuring proper alignment and a secure connection. The sections can also be removed individually to be replaced if prematurely worn in one place on the mouldboard. The sections can also be moved around on the mouldboard periodically if they are wearing unevenly.

